

MORE POWER : LESS NOISE

**CS1: KAWASAKI CONCOURS 14
SLIP-ON
INSTALLATION INSTRUCTIONS
PART# 43511/33511**



Congratulations, you have purchased the finest exhaust system for your motorcycle on the market. Your Vance & Hines exhaust system is designed and crafted for maximum performance, a perfect fit, a great sound and unbeatable style. Please follow the installation instructions below and if you have any questions, please call our technical support line at (562) 926-5291.

Attention installer (if other than owner), please forward this instruction sheet to the owner of this product. These instructions contain valuable information to the end user.

**BEFORE
YOU BEGIN**

- Make sure your bike is on a flat and stable surface before beginning this install.
- Before you start work make sure you have protective clothes and eyewear.
- You will need the following tools to perform the installation:
 - 10 & 12mm sockets and ratchet
 - 13 & 14mm combination wrenches
 - 5 and 6mm Allen wrench
 - Small flatblade screwdriver

READ ALL INSTRUCTIONS BEFORE BEGINNING INSTALLATION

**STOCK EXHAUST
SYSTEM REMOVAL**

1. Remove the right side saddlebag, place it aside until installation is complete.
2. Loosen the OE clamp holding the mid-pipe onto the header collector.
3. Loosen and remove the bolt holding the mid-pipe to the frame mounting tab.
4. Loosen and remove the bolt holding the OE muffler body to the footpeg bracket. Remove the muffler body and mid-pipe, being careful not to drop the muffler, it is heavy.

VANCE & HINES OPTIONAL ACCESSORIES

FUELPAK

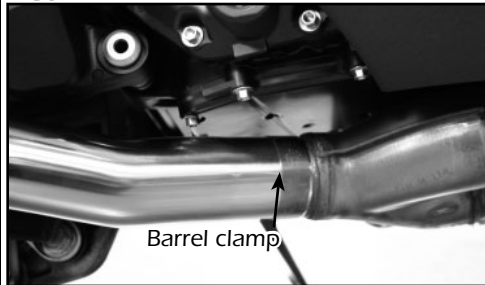


Take the guess work out of fuel injection with Fuelpak Fuel Management. Visit fuelpakfi.com for more information and to find out if your application is supported. Contact your local dealer or call (562) 921-0071 to order. Fuelpak is intended for racing or off-highway use only, and is not legal for sale or use in California on pollution-controlled vehicles.

**SPARE PARTS &
ACCESSORIES**

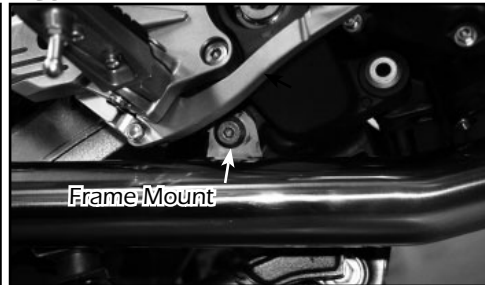
1. 1 - 1/2" Sound lowering Right Insert P/N: A180SN-R
2. 1 - 1/2" Sound lowering Left Insert P/N: A181SN-R
3. 1 - 5/8" Sound lowering Right Insert P/N: A175SN-R
4. 1 - 5/8" Sound lowering Left Insert P/N: A176SN-R
5. 1 - 3/4" Sound lowering Right Insert P/N: A170SN-R
6. 1 - 3/4" Sound lowering Left Insert P/N: A171SN-R
7. 1 - 7/8" Sound lowering Right Insert P/N: A165SN-R
8. 1 - 7/8" Sound lowering Left Insert P/N: A166SN-R
9. 2" Sound lowering Right Insert P/N: A160SN-R
10. 2" Sound lowering Right Insert P/N: A161SN-R
11. Muffler Re-Pack P/N: A230FG-R

FIGURE 1



Barrel clamp

FIGURE 2

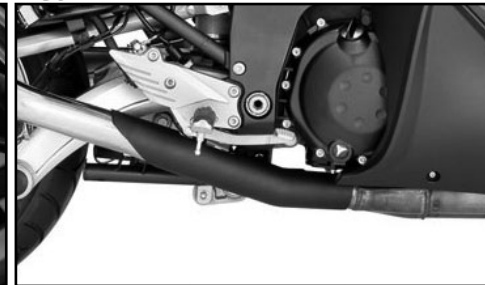


Frame Mount

FIGURE 3

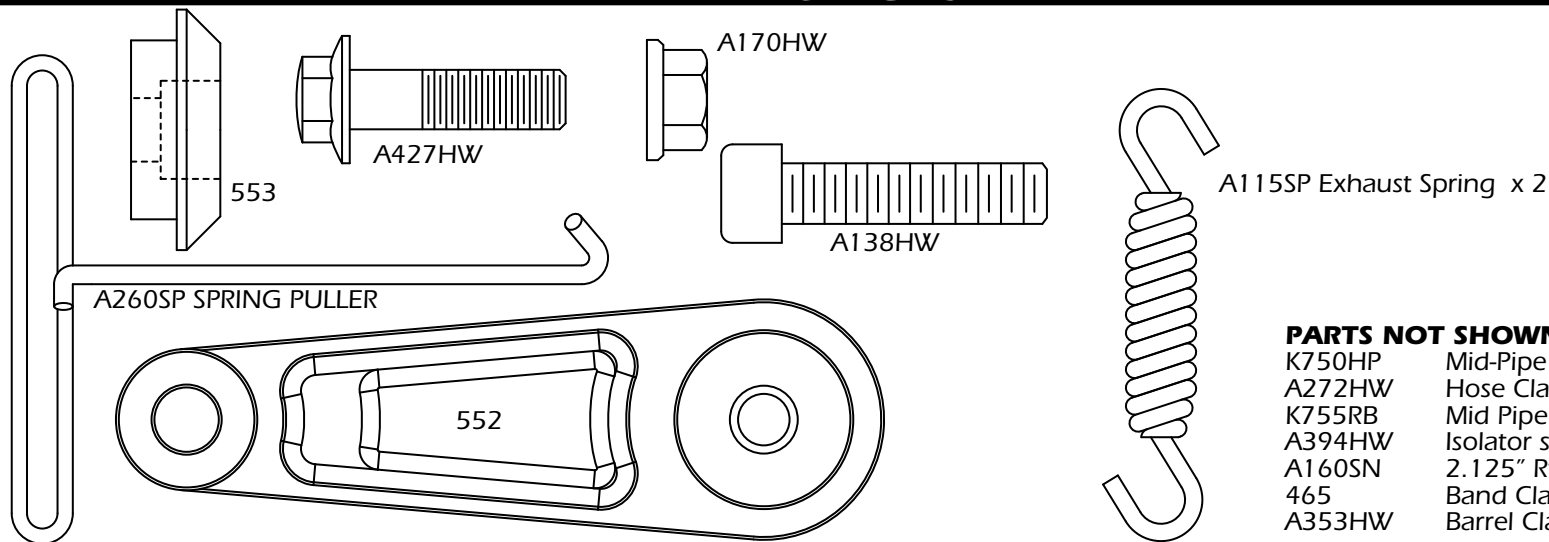


FIGURE 4



1. Remove center stand rubber bumper from OE mid-pipe, and install in provided bracket on mid-pipe.
2. Place provided barrel clamp (A353HW) over the slotted end of new mid-pipe and feed mid-pipe onto collector, lining up the frame bracket mount tab (figure 1)
3. Install OE bolt through frame bracket mount tab, and finger tighten with nut. (figure 2)
4. Put isolator strap (A394HW) inside the #465 band clamp, and press into place. Be sure to align the straps so that there is not a large gap on either end of the band clamp, and that it is seated evenly all the way around the band clamp.
5. Remove rubber footpeg isolator insert, and install provided drop bracket and cap with provided screw (A138HW) (figure 3)
6. Slide muffler body onto mid-pipe, aligning band clamp/strap assembly with front of drop bracket. Install provided bolt (A427HW) and nut (A170HW) into drop bracket, finger tighten. (figure 3)
7. Install exhaust springs onto clips on mid-pipe and muffler body.
8. Install and align mid-pipe heat shield using the hose clamps provided (figure 4). Heat shield hose clamps should be installed between tabs on center stand stop bracket. You may wish to add heat shield to mid-pipe before mid-pipe installation (step 2)
9. Align and tighten the muffler body and band clamp so that all the parts are even and the muffler is aligned when viewed from the rear of the motorcycle. NOTE: To adjust fitment, it may be necessary to rotate the tail pipe or muffler independently until proper alignment of the muffler is achieved.
10. Rotate and tighten the barrel clamp so that it is as hidden as possible and will not contact any moving suspension linkage parts.
11. After installation and before starting your motorcycle, completely clean pipes and heat shields with warm soapy water and a clean soft cloth. Dry with a clean towel. NOTE: any residue, oil, or fingerprints will stain the finish. Do NOT use anything abrasive to clean the pipes as it may remove the finish.
12. Be sure to tighten all hardware before starting your motorcycle.

PACKING LIST



PARTS NOT SHOWN:

K750HP	Mid-Pipe Heat Shield	x 1
A272HW	Hose Clamp	x 2
K755RB	Mid Pipe	x 1
A394HW	Isolator strap	x 1
A160SN	2.125" Rt insert (in muffler)	x 1
465	Band Clamp	x 1
A353HW	Barrel Clamp	x 1

WARRANTY

All of our exhaust systems are warranted against defects in material and/or workmanship for a period of 90 days. This warranty shall be limited to the repair or replacement of the system, which may be proven defective under normal use. We will not warranty any system that has been abused, misused, improperly installed, or modified. Failure to follow muffler packing instructions and maintenance will also not be covered under warranty.