

Contact Tech Support if you have any issues or questions

Techsupport@LowandMean.com or 928-680-6660

© 2006-2014 Low and Mean L.L.C.™, All rights reserved.



STAR BOLT REAR TURN SIGNAL ELIMINATOR

INSTALLATION INSTRUCTIONS

LM-04B-225



Scan the QR code to the left to be directed to the **How To Video** by Low and Mean

←
Let us know how your installation went. Send an email to techsupport@lowandmean.com



Parts Included:

Rear Eliminator Part
W/LED

READ ALL INSTRUCTIONS BEFORE BEGINNING INSTALLATION

- 1 Remove the Bolt Seat.
- 2 Disconnect the Cable running to the rear lights. Fig. 1
- 3 Remove Fender - 2 bolts on each side.
- 4 Turn Fender upside down and remove the 4 bolts holding on the rear plastic bracket so you can remove the rear light assembly. Fig. 2
- 5 Unplug both turn signal cables .
- 6 Remove fender struts then remove turn signals from the struts. Fig. 3
- 7 Cut connectors off turn signals - use them to rewire to your new Low and Mean turn signal eliminator.
- 8 Position the Low and Mean Turn Signal Eliminator in place - plug into the 2 turn signal connectors. Fig. 4
- 9 Bolt your new Low and Mean Turn Signal Eliminator into place using the stock hardware.
- 10 Reattach the fender strut to the fender.
- 11 Re-install rear fender. Make sure you reconnect the wire harness for the turn signals and then reinstall your seat.

Fig. 1

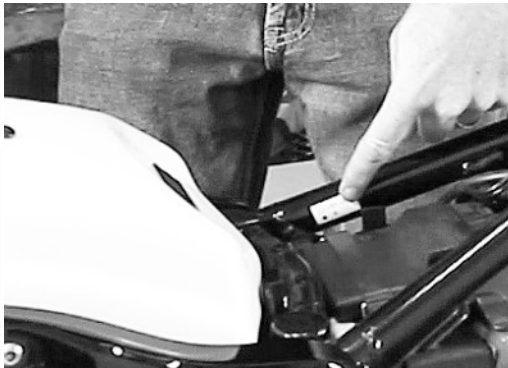

Fig. 2



Fig. 3

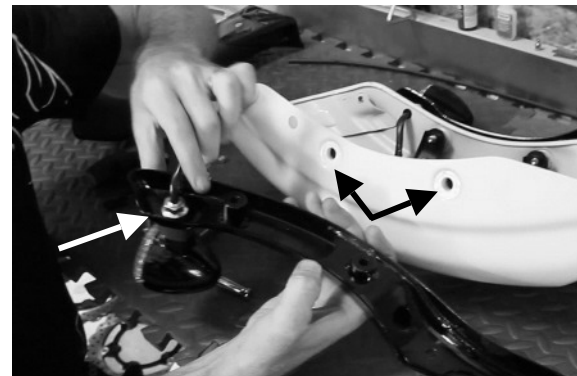
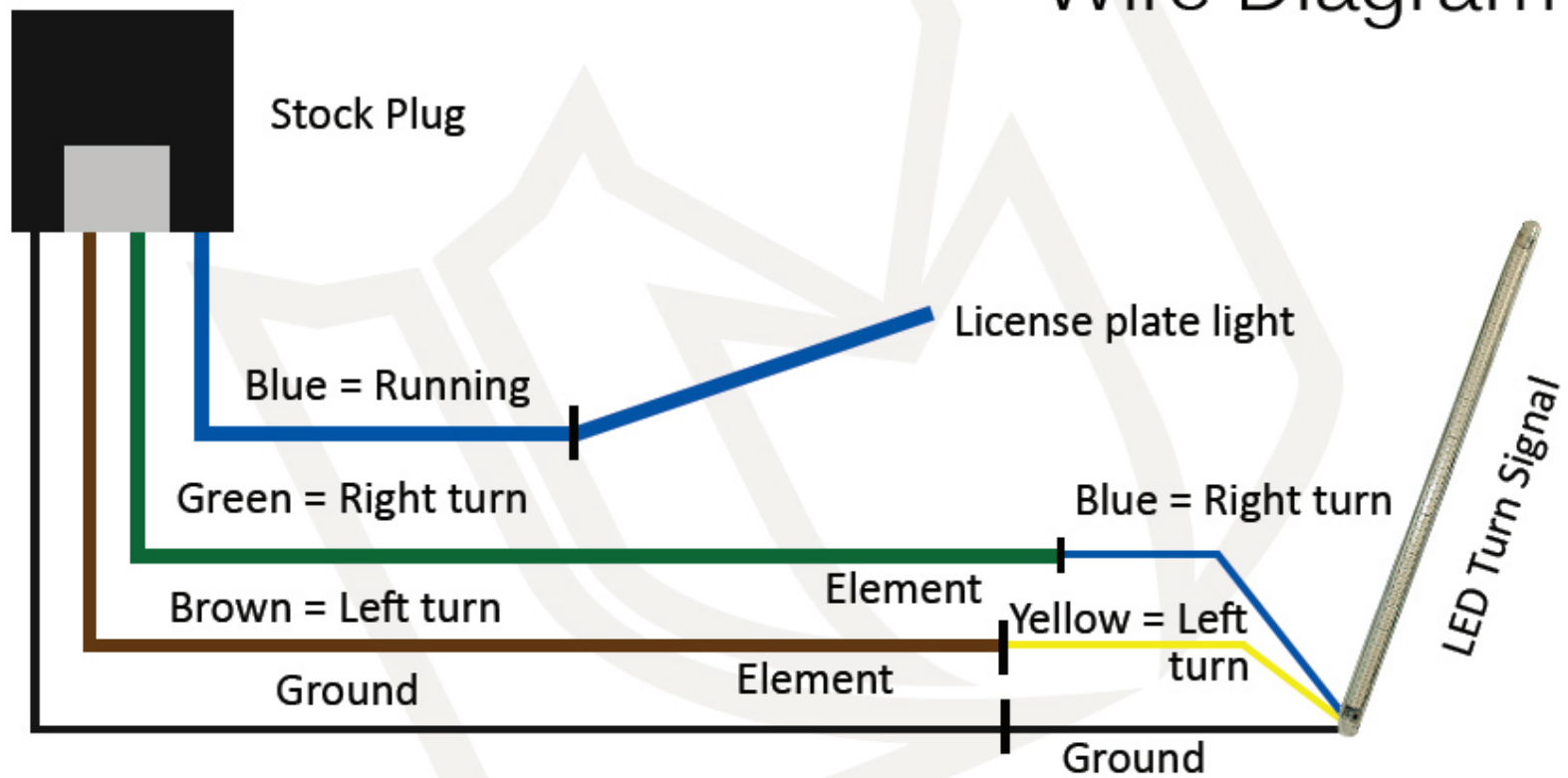

Fig. 4



Star Bolt Rear Turn LED Eliminator Wire Diagram



**Wire diagram setup may vary from year to year. This diagram is for the Yamaha Star Bolt 2014.