



CUSTOM CHROME

Instructions

Adjustable Rear Floorboard Kits CCI #09-888 and 09-904

CCI #09-904
FXR 1982-UP
FLSTC 1990-UP (requires 28-927 relocation kit)

BILL OF MATERIAL

NO.	QTY	DESCRIPTION
1	1	MINI FLOORBOARD SET
2	2	SLIDER STAR
3	2	DOG BONE
4	1	OFFSET STAR (LEFT)
5	1	OFFSET STAR (RIGHT) (NOT SHOWN)
6	2	Mount CHAIRLIFT
7	2	3/8"-16 UNC X 1.50" LONG SOCKET HEAD SCREW
8	2	3/8"-16 UNC NYLOCK NUT
9	2	7/16"-20 UNC X 1.50" LONG SOCKET HEAD SCREW
10	2	7/16" FLAT WASHER
11	2	7/16" LOCK WASHER
12	2	FLAT SPRING
13	2	7/16"-20 UNC X 1.00" LONG SOCKET HEAD SCREW
14	2	FLOORBOARD WASHER
15	1	1/2" I.D. X 3/8" WIDE SPACER

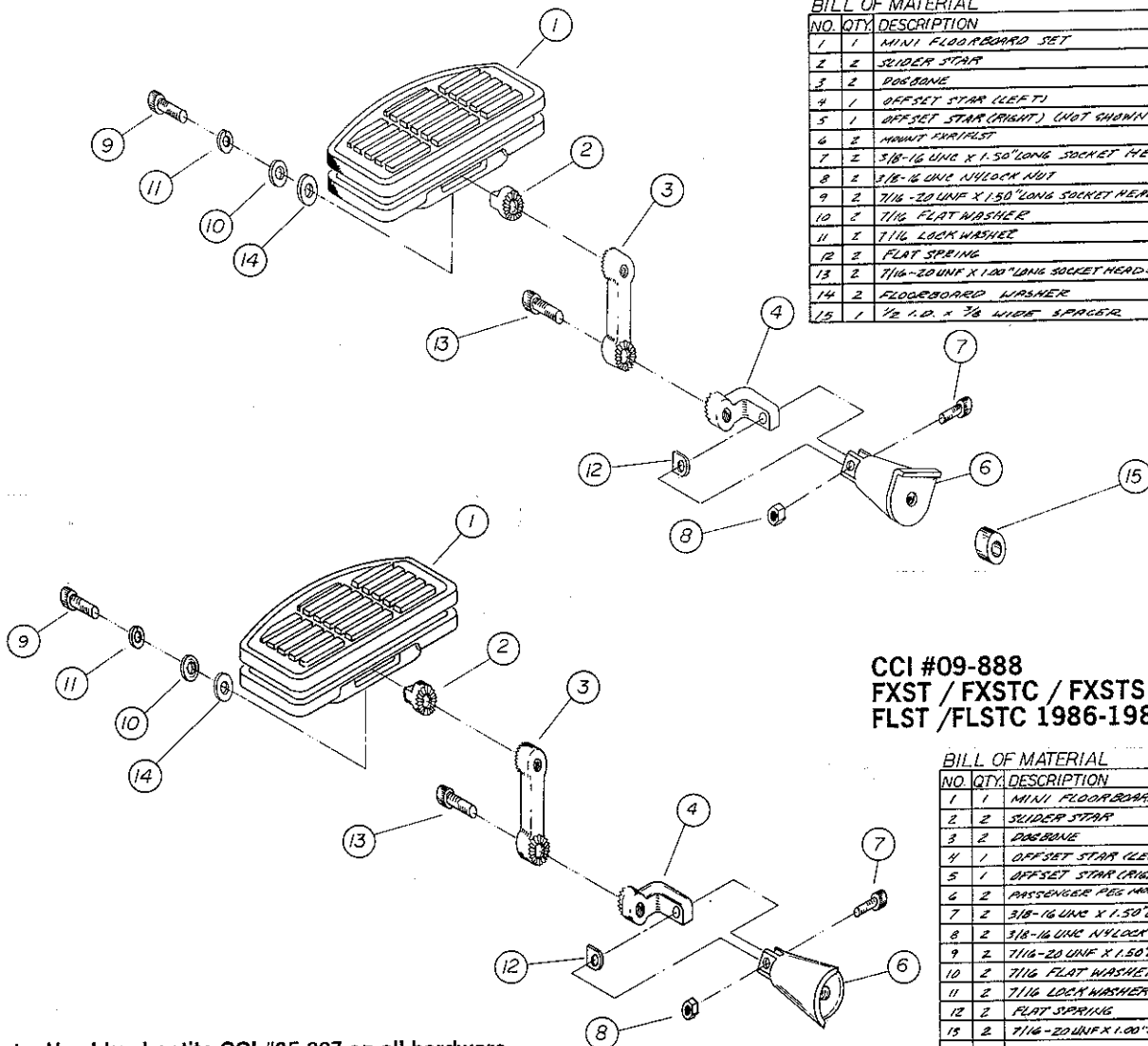

CCI #09-888
FXST / FXSTC / FXSTS 1984-UP
FLST / FLSTC 1986-1989

BILL OF MATERIAL

NO.	QTY	DESCRIPTION
1	1	MINI FLOORBOARD SET
2	2	SLIDER STAR
3	2	DOG BONE
4	1	OFFSET STAR (LEFT)
5	1	OFFSET STAR (RIGHT) (NOT SHOWN)
6	2	PASSENGER PEG MOUNT POST
7	2	3/8"-16 UNC X 1.50" LONG SOCKET HEAD SCREW
8	2	3/8"-16 UNC NYLOCK NUT
9	2	7/16"-20 UNC X 1.50" LONG SOCKET HEAD SCREW
10	2	7/16" FLAT WASHER
11	2	7/16" LOCK WASHER
12	2	FLAT SPRING
13	2	7/16"-20 UNC X 1.00" LONG SOCKET HEAD SCREW
14	2	FLOORBOARD WASHER

Note: Use blue Loctite CCI #35-007 on all hardware.

- Remove existing footpegs and peg mounts, retaining all hardware
- 2A. For CCI #09-888, install passenger peg mount (6) to frame using original 1/2" bolt and lockwasher. Tighten securely.
- 2B. When installing CCI #09-904 on FXR models, install mount (6) with tab upward using original 1/2" bolt and lockwasher. Tighten securely.
- 2C. When installing CCI #09-904 on 1990-up FLSTC, using CCI #28-927 relocation kit, install brackets with spacers (15) between bracket and frame. Secure mounts and bracket using provided 1/2" bolts and lockwashers. Tighten securely.
3. Install offset star mount (4) into female mount by placing spring (12) into clevis and pushing male star in as shown. Secure star mount using 7/16" bolt (7) and locknut (8)
4. Loosely install floorboard (1) to dog bone (3) using 7/16" bolt (9), lockwasher (11), flatwasher (10), thick floorboard washer (14) and slider star (2) as shown.
5. Install dog bone to offset star mount using 3/8" bolt (13), position dog bone as desired and tighten securely.

Note: All intended floorboard locations must be checked for ground and accessory clearances. Custom Chrome strongly recommends a minimum 9" ground clearance for all possible cornering angles.

6. Rotate floorboard to desired position and tighten securely.
7. Recheck all hardware and clearances before test driving motorcycle.

CCI #09-8881
3/16/93