



CUSTOM CHROME[®]

Instructions

Wide Stem Mirror Relocation Mount For OEM Handlebar Master Cylinder 1996 to Present CCI #27-443 Chrome CCI #27-444 Black

Bill Of Materials

No.	Qty.	Description	Part No.
1	1	Mirror Mount	27-443/27-444
2	1	5/16" -24x1-3/4" Socket Head Bolt	32-142
3	1	5/16" Flat Washer	25-177
4	1	5/16" -24 Nylon Lock Nut	14-626
5	1	Snap Cap Plug	32-352

Copyright © 1996 Custom Chrome, Inc.

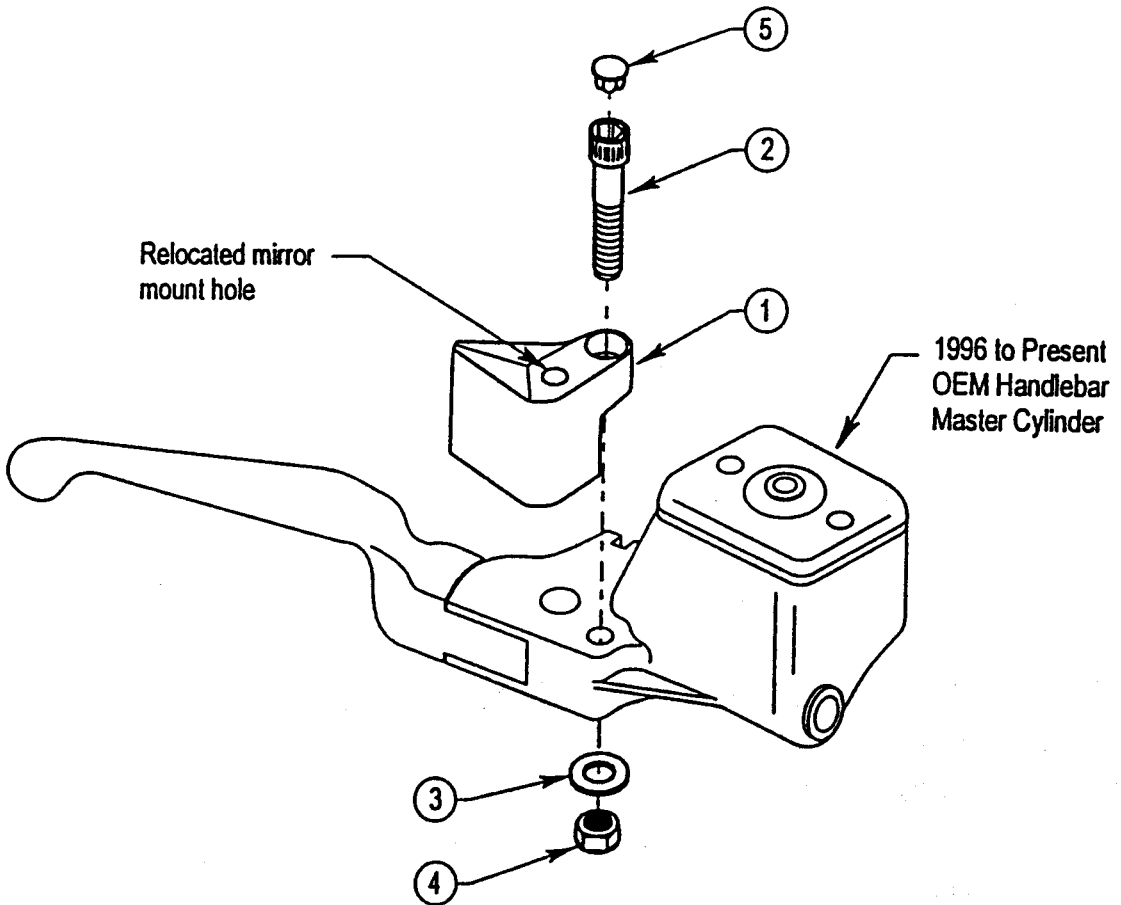

Note: Use Loctite™ (CCI #35-007) on first three threads of all hardware, before final assembly.

1. Remove existing mirror from mount, if present.
2. Place mirror mount (1) onto OEM handlebar master cylinder housing and align mounting holes. Install socket head bolt (2), flat washer (3) and nylock nut (4). Tighten securely. Install snap cap plug (5).
3. Place your mirror assembly into the relocated mirror mount hole and install. Tighten mirror assembly securely.