

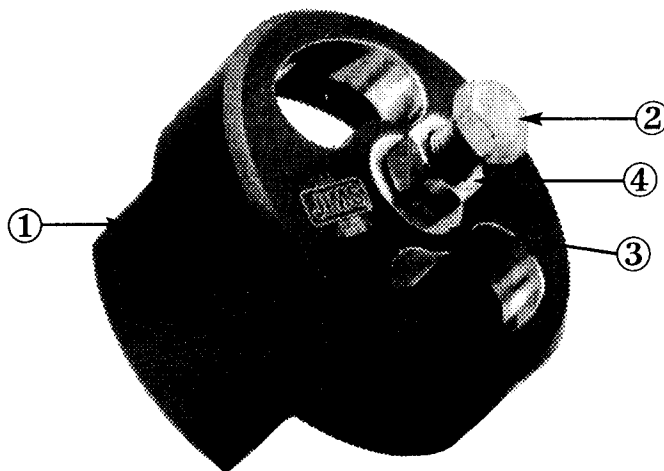

INSTRUCTION SHEET FOR TOOL NO.38515-90

CLUTCH SPRING COMPRESSOR USE ON BIG TWIN 1990-PRESENT



1. Refer to H.D.® Service Manual for removal of primary cover.
2. Loosen jam nut and remove adjuster screw and adjuster nut.
3. Hold cup portion of tool #38515-90-1, up against clutch diaphragm.
4. Slip forcing bolt #2036 through hole in top of tool with nut #2033 almost to the hex end of bolt, with washer #2037 in front of nut. Note: Apply oil to all threads and pushing surfaces.
5. Thread forcing screw into the hole in release plate at least 5 complete turns.
6. While keeping bolt from turning, turn nut with washer up against tool . Compress the diaphragm spring inward just enough to remove retaining ring.
7. Remove retaining ring.
8. Slowly remove tool with pressure plate attached. Caution: Do not loosen spring compressing tool if you are not replacing the pressure plate.
9. Clutch can now be disassembled.

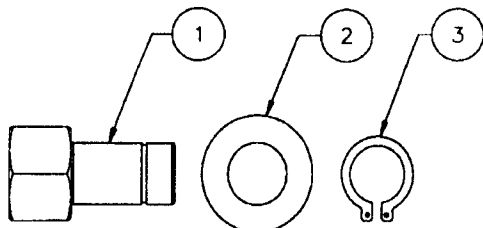

PARTS AVAILABLE SEPARATELY

No.	Qty.	Description	Part No.
1	1	CUP	38515-90-1
2	1	BOLT	2036
3	1	WASHER	2037
4	1	HEX NUT	2033

**CAUTION: WEAR SAFETY GLASSES. EXCESSIVE FORCE MAY DAMAGE PARTS OR TOOLS.
WARNING DISCONNECT NEGATIVE CABLE OF BATTERY TO AVOID ACCIDENTAL START UPS.**

"FROM THE TRACK... TO THE STREET!"